



# Mainsail

Sail Service Adriatic d.o.o.

Pojje bb

85000 Bar

Montenegro

Tel: +382 69 297705 / 207706

E-Mail: [contact@sailservice-adriatic.com](mailto:contact@sailservice-adriatic.com)

Customer: .....

Boat type/name: .....

## Preferences

- Full battens /  short battens
- Tapered battens
- Roach head
- Shape stripes, col.: \_\_\_\_\_, pcs.: \_\_\_\_\_
- Window, pcs: \_\_\_\_\_
- Class sign: \_\_\_\_\_
- Sail number: \_\_\_\_\_
- Advertising: \_\_\_\_\_

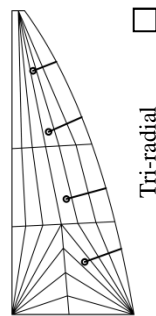

Tri-radial

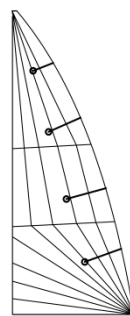

Bi-radial

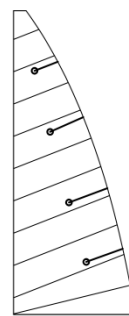

Cross-cut

Boom attachment:

- clew slider /  velcro-webbing loop
- free foot /  footrope

Reef: Portside / Starboard

- 1\_ ;  2\_ ;  3\_

Notes:

## Dimension

Area: \_\_\_\_\_ m<sup>2</sup>

- 1 Luff \_\_\_\_\_ mm
- 2 Leech \_\_\_\_\_ mm
- 3 Foot \_\_\_\_\_ mm
- 4 Width Head \_\_\_\_\_ mm

By main halyard, hoist a measure tape and measure distance from:

- 5 block on the mast top to top of boom \_\_\_\_\_ mm
- 6 block on the mast top to peak \_\_\_\_\_ mm
- 7 between measurement bands [P] \_\_\_\_\_ mm

Dimension from aft mast to:

- 8 measurement band boom[E] \_\_\_\_\_ mm
- 9 boom peak \_\_\_\_\_ mm
- 10 backstay (along boom) \_\_\_\_\_ mm
- 11 mast crane \_\_\_\_\_ mm
- 12 start of luff groove or track \_\_\_\_\_ mm
- 13 reef hook aft/tack pin aft \_\_\_\_\_ mm
- 14 start of boom groove or track boom \_\_\_\_\_ mm
- 15 Tack back \_\_\_\_\_ mm
- 16 Tack up \_\_\_\_\_ mm

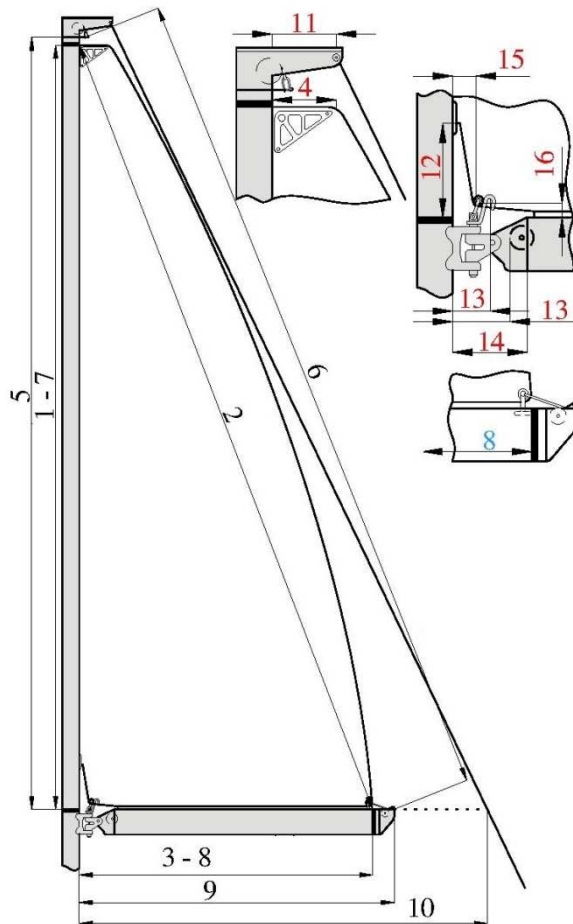

## Design parameters

Mast & boom groove/track type:

Mast                      Boom

- Profile: \_\_\_\_\_
- 17 A \_\_\_\_\_ mm      \_\_\_\_\_ mm
  - 18 B \_\_\_\_\_ mm      \_\_\_\_\_ mm
  - 19 C \_\_\_\_\_ mm      \_\_\_\_\_ mm

a)

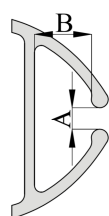

b)



c)

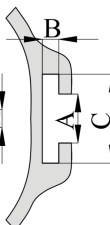

d)

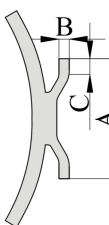

Signature, date